

Gabelendmuffen

■ GI52/45,B20 Gabelendmuffen

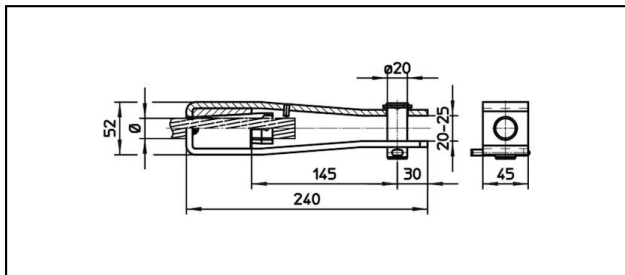

Anwendung





Zugfeste Verbindungen für Leiter aus Cu, Bz, Stahl und Staku

Eigenschaften

Betriebslast min. 3 kN / max. 25 kN
Bruchlast des Gehäuses min. 120 kN

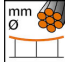
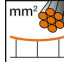
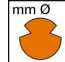
Material

Gehäuse Stahl rostfrei / Konus AIBz bzw. Stahl rostfrei

Artikel-Nr.									
610.105.000	FD150			14.5	150			1.66	

Technische Spezifikationen: **Gabelendmuffen GI52/45,B20**

Artikel-Nr.	610.105.000
Bahn Produkt Name	FD150
Fahrdraht Durchmesser	14.5 mm
Fahrdraht Fläche	150 mm ²
Kommerzielle Spezifikation	
Zolltarifnummer	0
Ursprungsland	unbestimmt

