

Gabelendmuffen

■ GI50/40,B20 Gabelendmuffen

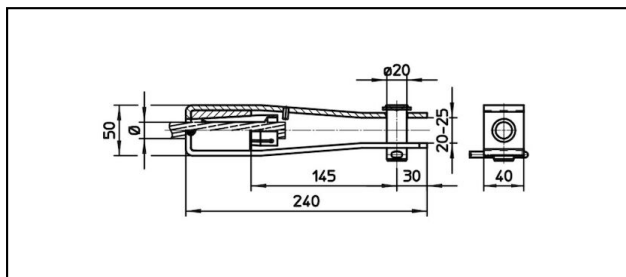

Anwendung





Zugfeste Verbindungen für Leiter aus Cu, Bz, Stahl und Staku

Eigenschaften

Betriebslast min. 3 kN / max. 25 kN
Min. Bruchlast des Gehäuses 80 kN

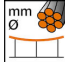
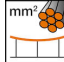
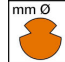
Material

Gehäuse Stahl rostfrei / Konus AIBz

Artikel-Nr.									
610.065.000	S242	21	242					1.51	1

Technische Spezifikationen: **Gabelendmuffen GI50/40,B20**

Artikel-Nr.	610.065.000
Bahn Produkt Name	S242
Tragseil Durchmesser	21 mm
Tragseile Seilfläche	242 mm ²
Kommerzielle Spezifikation	
Zolltarifnummer	85359020
Ursprungsland	unbestimmt

