

Gabelendmuffen

GI50/40,B16 Gabelendmuffen

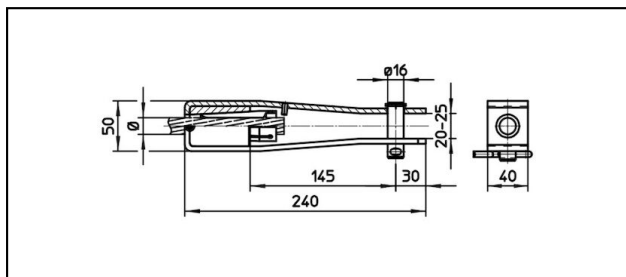

Anwendung

Zugfeste Verbindungen für Leiter aus Cu, Bz, Stahl und Staku





Eigenschaften

Betriebslast min. 3 kN / max. 25 kN

Bruchlast des Gehäuses min. 80 kN

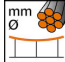
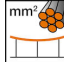
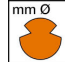
Material

Gehäuse Stahl rostfrei / Konus AIBz resp. Stahl rostfrei

Artikel-Nr.									
610.047.000	FD150/S150	15.8	150	15.8	150			1.51	

Technische Spezifikationen: **Gabelendmuffen GI50/40,B16**

Artikel-Nr.	610.047.000
Bahn Produkt Name	FD150/S150
Tragseil Durchmesser	15.8 mm
Tragseile Seilfläche	150 mm ²
Fahrdraht Durchmesser	15.8 mm
Fahrdraht Fläche	150 mm ²
Kommerzielle Spezifikation	
Zolltarifnummer	85359020
Ursprungsland	CH

